

# LIVE Plunger Lock LL201

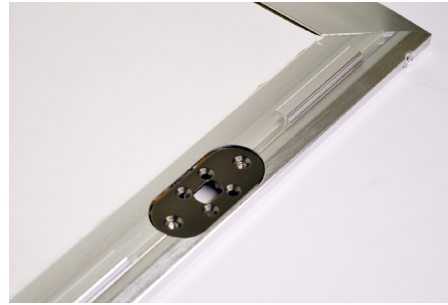

**1 Optional:**  
For ease of installation, use an Installer Key (if you have one) to unlock the lock. If using the Installer Key in a lock with the battery tabs in place, it will pause the lock in an unlocked state.



**2** Place the adapter plate into the recess in the door panel.



**3** Insert and tighten the provided screws to secure the adapter plate to the door panel.



**4** Use the provided alcohol wipe to clean the front side of the door panel where the lock will be placed. Allow it to dry completely.



**5** Determine the lock mounting orientation.



**6** Peel the 2 adhesives from the lock body.



**7** Place the lock body onto the door panel so that the plunger fits through the center hole in the adapter plate. Apply pressure for at least 10 seconds.



**8** Insert and tighten the 4 smaller screws to secure the lock body to the door panel.

# LIVE Plunger Lock LL201



9 Pull the battery tabs.

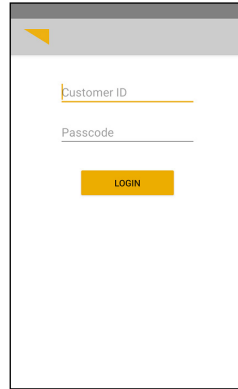

10 Open the InVue LIVE Access app and enter your login credentials. **Note:** Your Passcode is the same as your OKM User PIN.

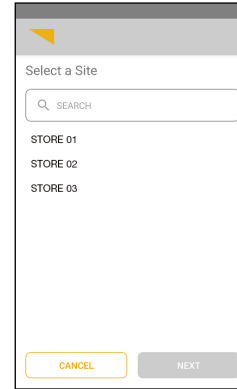

11 If prompted, select the site where the lock has been installed.

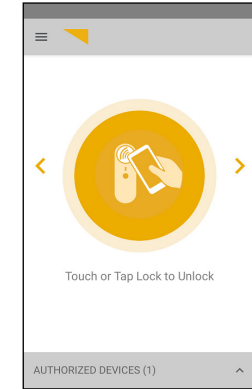

12 Tap the lock knob with the NFC antenna of the device being used. The lock will unlock and relock within 4 seconds.

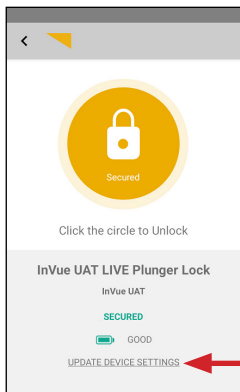

13 Click on the "Update Device Settings" link to modify the Device Name, Description, or Zone to complete the enrollment. **Note:** You must have the "Manage Devices" permission to see and access this link.

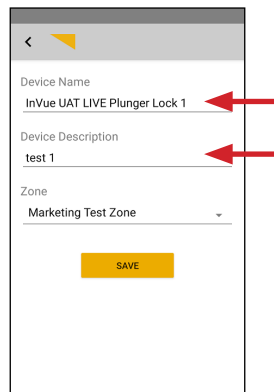

14 Rename the device and enter an optional description if desired.

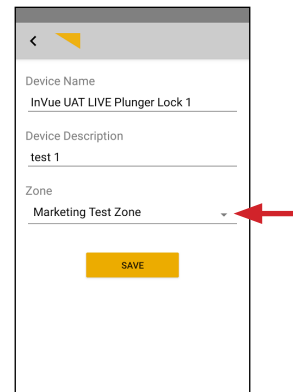

15 Assign the device to the appropriate Zone in your store or site. **Note:** Zones are created in Access Manager

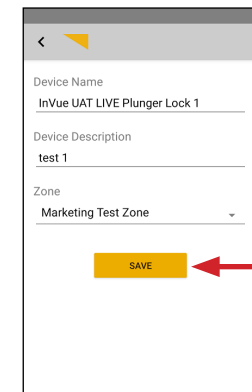

16 Click "Save" once the lock description fields have been filled out.

# LIVE Plunger Lock LL201



**17a Lock Activation Using OneKEY:**  
Place a charged and coded OneKEY against the lens on the lock and press the button the Key. The LED on the Key and the lock will flash green.



**17b** You will have several seconds to pull the knob out and slide the door panel open. If the LED on the lock flashes red before the lock is opened, it will need to be unlocked again.

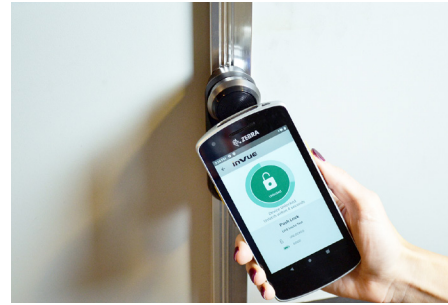

**18a Lock Activation Using NFC:**  
Open the InVue LIVE Access App on your smart device. Tap your device against the round panel on the lock.



**18b** Once confirmed by the App displaying "unlocked" and the LED flashing green, you will have several seconds to pull the knob out and slide the door panel open. If the LED on the lock flashes red before the lock is opened, it will need to be unlocked again.



**19a Using the 2D Barcode:**  
Insert a thin edged tool into the small notch between the lock body and the round plate.



**19b** Remove the panel to reveal the barcode.

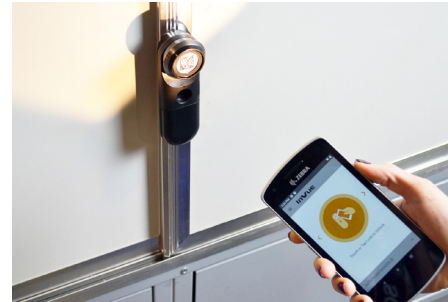

**20a Lock Activation Using Scanning Device:**  
If your smart device has a built in barcode reader, aim and scan the code on the front of the lock while the InVue LIVE Access App is open.



**20b** Once confirmed by the App displaying "unlocked" and the LED flashing green, you will have several seconds to pull the knob out and slide the door panel open. If the LED on the lock flashes red before the lock is opened, it will need to be unlocked again.

## LIVE Plunger Lock LL201

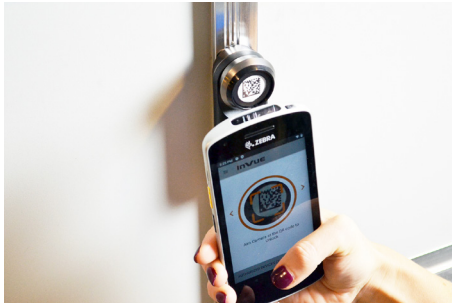

- 21a Lock Activation Using Device Camera:**  
Open the InVue LIVE Access App on your smart device and toggle to the “Camera Scan” screen. Center the barcode in the viewfinder.



- 21b** Once confirmed by the App displaying “unlocked” and the LED flashing green, you will have several seconds to pull the knob out and slide the door panel open. If the LED on the lock flashes red before the lock is opened, it will need to be unlocked again.



- 22 Battery Replacement Steps:**  
Place a magnet key near the end of the battery panel on the lock.  
**Note:** Even with low batteries the lock will still function with a OneKEY.



- 23** Remove the battery panel from the lock.



- 24** Replace the old batteries with new CR123A non-rechargeable lithium batteries.



- 25** Slide the battery panel back into place.



**Warning – Fire, Explosion, Burn Hazard:**

InVue recommends the use of Great Power or Energizer CR123A batteries. Use of other batteries, mixing of used and new or different battery chemistries may present a risk of leakage, fire, explosion and serious personal injury. Do not ingest, recharge, misuse, short circuit, improperly store or discard, disassemble or heat above 212°F (100°C). Keep away from children.